

AERODROME GROUND
MOVEMENT CHART - ICAO

TOWER 118.100
APRON 118.900

SARANSK, RUSSIA

SARANSK

PZ - 90.11 coordinates

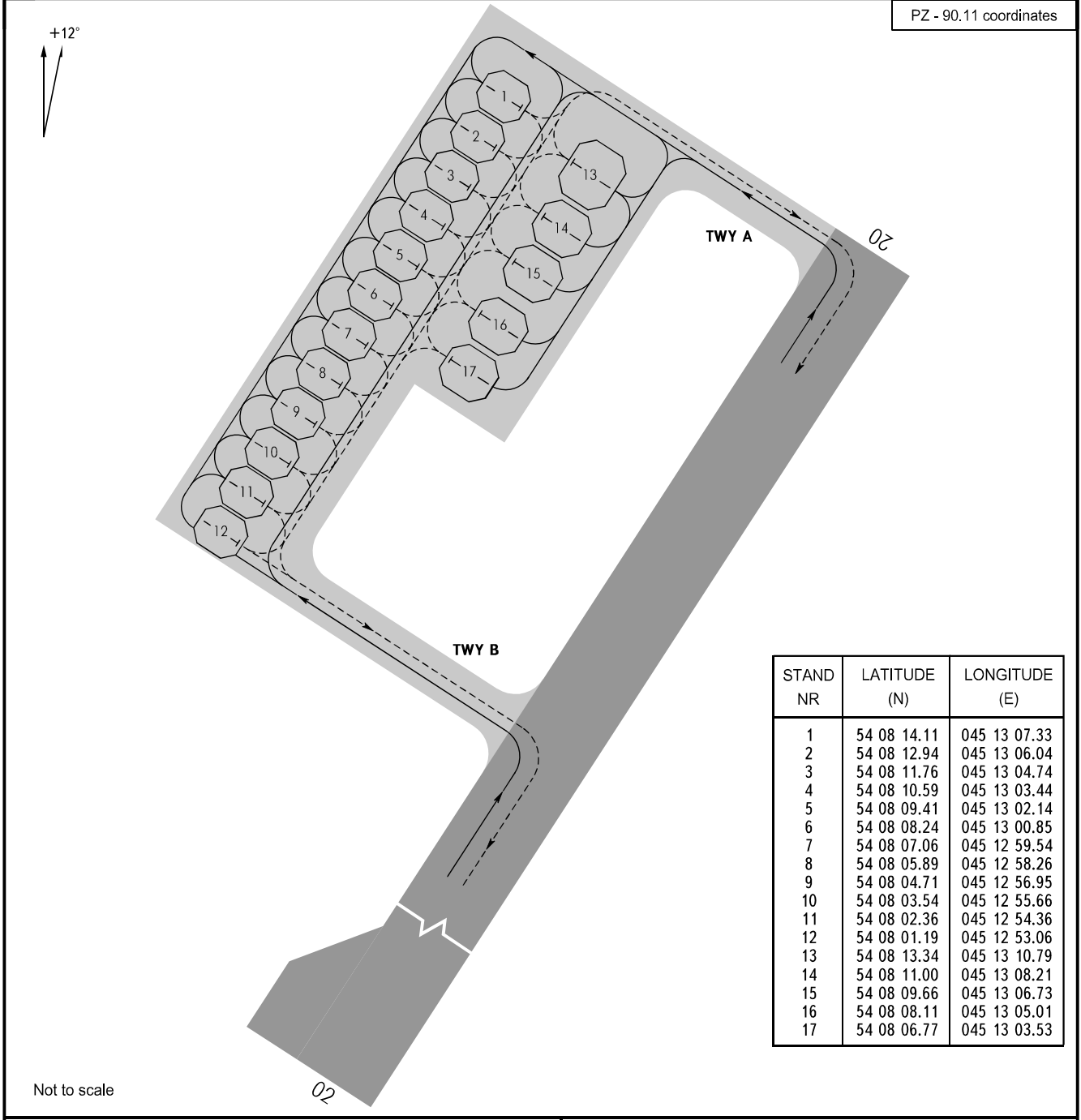

STAND NR	LATITUDE (N)	LONGITUDE (E)
1	54 08 14.11	045 13 07.33
2	54 08 12.94	045 13 06.04
3	54 08 11.76	045 13 04.74
4	54 08 10.59	045 13 03.44
5	54 08 09.41	045 13 02.14
6	54 08 08.24	045 13 00.85
7	54 08 07.06	045 12 59.54
8	54 08 05.89	045 12 58.26
9	54 08 04.71	045 12 56.95
10	54 08 03.54	045 12 55.66
11	54 08 02.36	045 12 54.36
12	54 08 01.19	045 12 53.06
13	54 08 13.34	045 13 10.79
14	54 08 11.00	045 13 08.21
15	54 08 09.66	045 13 06.73
16	54 08 08.11	045 13 05.01
17	54 08 06.77	045 13 03.53

Not to scale

APRON:
Surface: - Reinforced Concrete

TAXIWAYS:
Width: A, B - 21m
Surface: A, B - Reinforced Concrete
Strength: A, B - PCN 45/R/B/W/T

STANDS:
Surface: 1-17 - Reinforced Concrete
Strength: 1-12 - PCN 41/R/B/W/T
Strength: 13-17 - PCN 47/R/C/X/T

ACFT types:
An-24/148, Yak-40,
ATR-42/72, B737-300/400/500,
Cessna 208B and its modifications,
CRJ-100/200 and their modifications,
DA-42, EMB-120,
EMB -170/175/190/195 and their modifications,
RRJ-95, helicopters of all types

STANDS:
1-12
14-17

WARNING
Stands designated for ceratin ACFT types are also AVBL for parking of smaller ACFT (according to wingspan and length).

CHANGE: New chart