

**AERODROME  
CHART - ICAO**

**ARP**  
45°02'05"N  
039°10'13"E

**TOWER** 118.200  
**GROUND** 119.000

**KRASNODAR, RUSSIA**  
PASHKOVSKIY

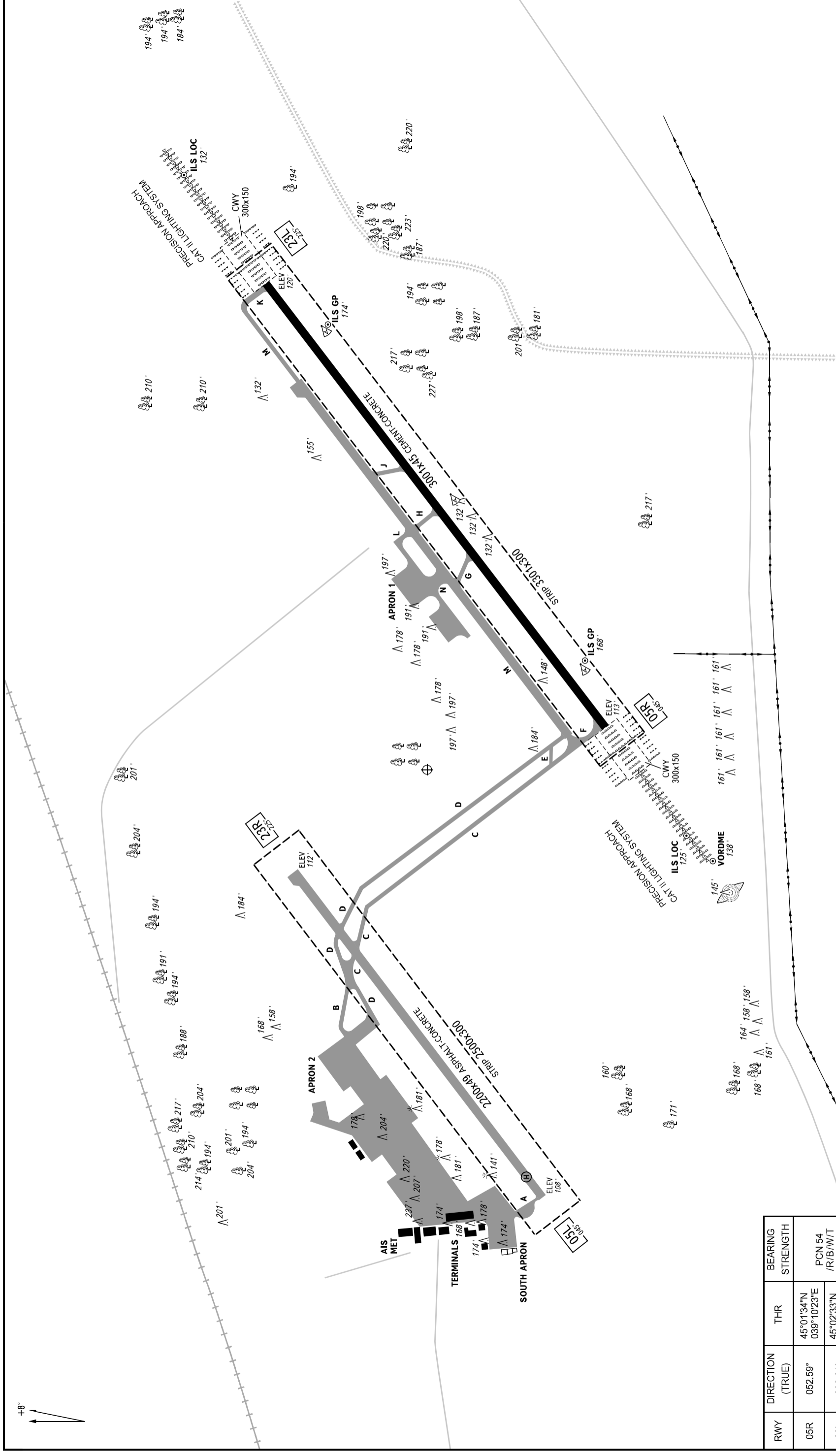

CHANGE: NIL

RWY	DIRECTION (TRUE)	THR	BEARING STRENGTH
05R	052.59°	45°01'34"N 039°10'23"E	PCN 54 /R/B/W/T
23L	232.61°	45°02'33"N 039°12'12"E	PCN 45 /F/D/X/T

ELEVATIONS IN FEET  
DIMENSIONS IN METRES  
BEARINGS ARE MAGNETIC



**WARNING**  
There is a fence segment along the perimeter of the aerodrome at 136m SE of RWY 05R/23L centre with lighting masts up to 12ft high above the runway surface.

MARKING AIDS RWY 05R / 23L AND EXIT TWY

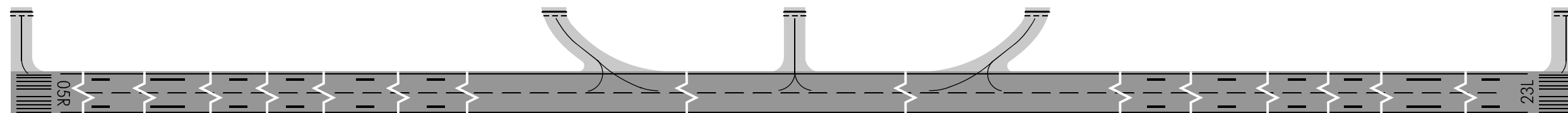

LIGHTING AIDS RWY 05R / 23L AND EXIT TWY

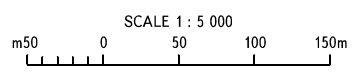
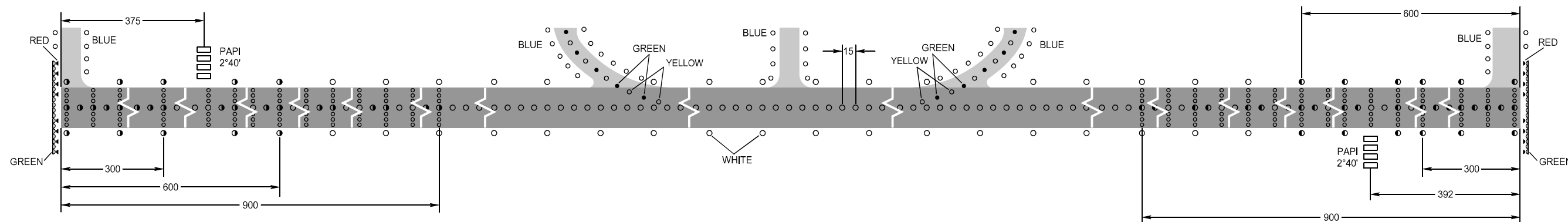

DIMENSIONS IN METRES

MARKING AIDS RWY 05L / 23R AND EXIT TWY

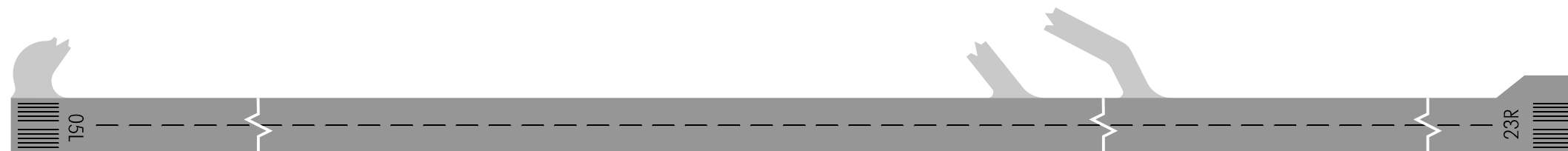

LIGHTING AIDS RWY 05L / 23R AND EXIT TWY

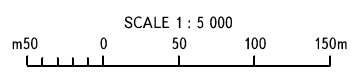

DIMENSIONS IN METRES

CHANGE: NIL